



ENERGY TUBULARS

API 5L LINE PIPE

API 5CT J55
TUBING & CASING

OCTG GREEN TUBE

Product line

LINE PIPE

API 5L X Grade Line Pipe

- ✓ 2" to 6" nominal pipe sizes

API 5L A25 Grade Line Pipe

- ✓ ½" OD to 4½" OD

OCTG

API 5CT J55 Tubing & Casing

- ✓ 2¾" to 7" PE only.

ET65 & ET80 Non API Proprietary Grades

- ✓ 2¾" to 13¾" PE only.

OCTG Green Tube

- ✓ 2¾" to 13¾" PE only.

Certifications and qualifications

- ✓ API 5CT, Warren, OH – Lic. #0588
- ✓ API 5L, Warren, OH – Lic. #0856
- ✓ API 5L, Wheatland, PA – Lic. #0080
- ✓ ISO 9001:2008 – Warren, OH
- ✓ ISO 9001:2015 – Wheatland, PA
- ✓ ISO/TS 16949:2009 – Niles, OH



API 5L Line Pipe Couplings

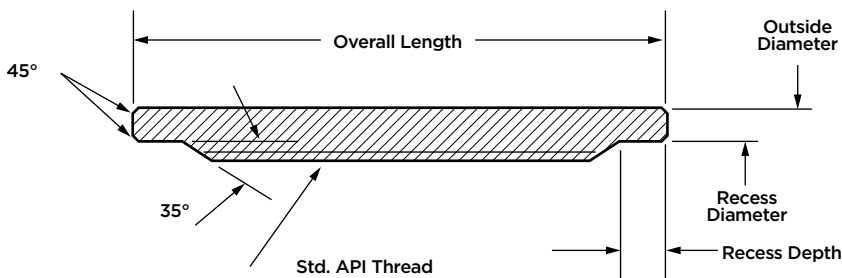

NOMINAL PIPE SIZE	THREADS PER INCH	OD	LENGTH +0.031, -0.000	RECESS DIAMETER +0.020, -0.000	RECESS +0.020, -0.000	PITCH DIAMETER	WEIGHT per 100 pcs
⅛	27	0.563	1.062	0.468	0.052	0.3736	4
¼	18	0.719	1.625	0.603	0.121	0.4916	9
⅜	18	0.875	1.625	0.738	0.115	0.6270	13
½	14	1.063	2.125	0.903	0.158	0.7784	24
¾	14	1.313	2.125	1.113	0.152	0.9889	34
1	11.5	1.576	2.625	1.378	0.224	1.2386	54
1¼	11.5	2.054	2.750	1.723	0.228	1.5834	103
1½	11.5	2.200	2.750	1.963	0.244	1.8223	90
2	11.5	2.875	2.875	2.469	0.238	2.2963	186
2½	8	3.375	4.125	2.969	0.492	2.7622	327
3	8	4.000	4.250	3.594	0.471	3.3885	409
3½	8	4.625	4.375	4.094	0.466	3.8888	592
4	8	5.200	4.500	4.594	0.492	4.3871	759

All API Line Pipe couplings are taper tapped.

OCTG Green Tube Capabilities by Mill

WARREN OCTG CAPABILITIES

SIZE	MASS	t*	MASS PE	L	GRADE
					GT = Green Tube, J = J55, WT = Proprietary Grade
2 3/8	4.70	0.190	4.44	R2	GT/J
2 7/8	6.50	0.217	6.17	R2	GT/J
3 1/2	9.30	0.254	8.81	R2	GT/J
4 1/2	9.50	0.224	9.41	R3	GT/J/WT
4 1/2	10.50	0.205	10.24	R3	GT/J/WT
4 1/2	11.60	0.250	11.36	R3	GT/J/WT
4 1/2	13.50	0.290	13.05	R3	GT
5 1/2	14.00	0.244	13.71	R3	GT/J/WT
5 1/2	15.50	0.275	15.36	R3	GT/J/WT
7	17.00	0.231	16.72	R3	J
7	20.00	0.272	19.56	R3	J

* t min: 0.156, t max: 0.300

API 5CT licensed #0856. Product is seam annealed. End condition: beveled. Hydro test: yes.

NILES OCTG CAPABILITIES

SIZE	MASS	t*	MASS PE	L	GRADE
					GT = Green Tube, J = J55, WT = Proprietary Grade
2 3/8	4.70	0.190	4.44	R2	GT
2 7/8	6.50	0.217	6.17	R2	GT
3 1/2	9.30	0.254	8.81	R2	GT
4 1/2	9.50	0.224	9.41	R3	GT
4 1/2	10.50	0.205	10.24	R3	GT
4 1/2	11.60	0.250	11.36	R3	GT
4 1/2	13.50	0.290	13.05	R3	GT
5	11.50	0.220	11.24	R3	GT
5	13.00	0.253	12.84	R3	GT
5	15.00	0.296	14.88	R3	GT
5	18.00	0.362	17.95	R3	GT
5 1/2	14.00	0.244	13.71	R3	GT
5 1/2	15.50	0.275	15.36	R3	GT
5 1/2	17.00	0.304	16.89	R3	GT
5 1/2	20.00	0.361	19.83	R3	GT
5 1/2	23.00	0.415	22.56	R3	GT

* t min: 0.190, t max: 0.425

Mill is not API 5CT licensed. Product is not seam annealed. End condition: mill saw cut. Hydro test: no.

HARROW OCTG CAPABILITIES

SIZE	MASS	t*	MASS PE	L	GRADE
					GT = Green Tube, J = J55, WT = Proprietary Grade
9 5/8	32.30	0.312	31.13	R3	WT40
9 5/8	36.00	0.352	34.89	R3	WT50
9 5/8	40.00	0.395	38.97	R3	GT
9 5/8	43.50	0.435	42.73	R3	GT
9 5/8	47.00	0.472	46.18	R3	GT
10 3/4	32.75	0.279	31.23	R3	GT
10 3/4	40.50	0.350	38.91	R3	GT
10 3/4	45.50	0.400	44.26	R3	GT
10 3/4	51.00	0.450	49.55	R3	GT
10 3/4	55.50	0.495	54.26	R3	GT
10 3/4	60.70	0.545	59.45	R3	GT
10 3/4	47.00	0.375	45.6	R3	GT
13 3/8	48.00	0.330	46.02	R3	WT50
13 3/8	54.50	0.380	52.79	R3	WT50
13 3/8	61.00	0.430	59.5	R3	GT
13 3/8	68.00	0.480	66.17	R3	GT
13 3/8	72.00	0.514	70.67	R3	GT

* t min: 0.250, t max: 0.570

Mill is not API 5CT licensed. Product is seam annealed. End condition: mill saw cut. Hydro test: no.

Line Pipe Capabilities by Mill

WHEATLAND LINE PIPE CAPABILITIES — SCHEDULE 40 (CBW), API 5L LINE PIPE A25

GRADE	PSL	NOMINAL PIPE SIZE	OD	t	WGT/FT		HYDRO	YIELD STRENGTH		TENSILE STRENGTH	
					PE	T & C		Min	Max	Min	Max
A25	1	½	0.840	0.109	0.85	0.86	700	25,400	—	45,000	—
A25	1	¾	1.050	0.113	1.13	1.14	700	25,400	—	45,000	—
A25	1	1	1.315	0.133	1.68	1.70	700	25,400	—	45,000	—
A25	1	1¼	1.660	0.140	2.27	2.30	1,000	25,400	—	45,000	—
A25	1	1½	1.900	0.145	2.72	2.75	1,000	25,400	—	45,000	—
A25	1	2	2.375	0.154	3.65	3.75	1,000	25,400	—	45,000	—
A25	1	2½	2.875	0.203	5.79	5.90	1,000	25,400	—	45,000	—
A25	1	3	3.500	0.216	7.58	7.70	1,000	25,400	—	45,000	—
A25	1	4	4.500	0.237	10.79	11.00	1,200	25,400	—	45,000	—

WHEATLAND LINE PIPE CAPABILITIES — SCHEDULE 80 (CBW), API 5L LINE PIPE A25

GRADE	PSL	NOMINAL PIPE SIZE	OD	t	WGT/FT		HYDRO	YIELD STRENGTH		TENSILE STRENGTH	
					PE	T & C		Min	Max	Min	Max
A25	1	½	0.840	0.147	1.09	1.09	850	25,400	—	45,000	—
A25	1	¾	1.050	0.154	1.48	1.48	850	25,400	—	45,000	—
A25	1	1	1.315	0.179	2.17	2.19	850	25,400	—	45,000	—
A25	1	1¼	1.660	0.191	3.00	3.03	1,300	25,400	—	45,000	—
A25	1	1½	1.900	0.200	3.63	3.65	1,300	25,400	—	45,000	—
A25	1	2	2.375	0.218	5.03	5.08	1,300	25,400	—	45,000	—
A25	1	3	3.500	0.300	10.26	10.35	1,300	25,400	—	45,000	—
A25	1	4	4.500	0.337	15.00	15.20	1,700	25,400	—	45,000	—

Line Pipe Capabilities by Mill

WARREN LINE PIPE CAPABILITIES (ERW), API 5L LINE PIPE X GRADE

GRADE	PSL	NOMINAL PIPE SIZE	OD	t	WGT/FT	HYDRO			YIELD STRENGTH		TENSILE STRENGTH	
						PE	Std	Alt	Min	Max	Min	Max
X42	1	2	2.375	0.154	3.65	2,970	4,090	42,100	—	60,200	—	
X42	1	2	2.375	0.218	5.02	2,970	5,800	42,100	—	60,200	—	
X42	1	2½	2.875	0.203	5.80	2,970	4,460	42,100	—	60,200	—	
X42	1	3	3.500	0.188	6.65	2,710	3,390	42,100	—	60,200	—	
X42	1	3	3.500	0.216	7.58	2,970	3,900	42,100	—	60,200	—	
X42	1	3	3.500	0.300	10.26	2,970	5,410	42,100	—	60,200	—	
X42	1	4	4.500	0.156	7.24	1,750	2,190	42,100	—	60,200	—	
X42	1	4	4.500	0.188	8.66	2,110	2,640	42,100	—	60,200	—	
X42	1	4	4.500	0.219	10.02	2,460	3,070	42,100	—	60,200	—	
X42	1	4	4.500	0.237	10.80	2,660	3,330	42,100	—	60,200	—	
X42	1	6	6.625	0.156	10.78	1,490	1,490	42,100	—	60,200	—	
X42	1	6	6.625	0.188	12.92	1,790	1,790	42,100	—	60,200	—	
X42	1	6	6.625	0.219	14.99	2,088	2,090	42,100	—	60,200	—	
X42	1	6	6.625	0.250	17.02	2,380	2,380	42,100	—	60,200	—	
X42	1	6	6.625	0.280	18.99	2,670	2,670	42,100	—	60,200	—	
X52	1	2	2.375	0.154	3.65	2,970	5,080	52,200	76,900	66,700	110,200	
X52	1	2	2.375	0.218	5.02	2,970	7,190	52,200	76,900	66,700	110,200	
X52	1	2½	2.875	0.203	5.80	2,970	5,530	52,200	76,900	66,700	110,200	
X52	2	3	3.500	0.188	6.65	2,970	4,210	52,200	76,900	66,700	110,200	
X52	2	3	3.500	0.216	7.58	2,970	4,830	52,200	76,900	66,700	110,200	
X52	2	3	3.500	0.300	10.26	2,970	6,710	52,200	76,900	66,700	110,200	
X52	2	4	4.500	0.156	7.24	2,170	2,710	52,200	76,900	66,700	110,200	
X52	2	4	4.500	0.188	8.66	2,620	3,270	52,200	76,900	66,700	110,200	
X52	2	4	4.500	0.219	10.02	2,970	3,810	52,200	76,900	66,700	110,200	
X52	2	4	4.500	0.237	10.80	2,970	4,120	52,200	76,900	66,700	110,200	
X52	2	6	6.625	0.156	10.78	1,840	1,840	52,200	76,900	66,700	110,200	
X52	2	6	6.625	0.188	12.92	2,220	2,220	52,200	76,900	66,700	110,200	
X52	2	6	6.625	0.219	14.99	2,590	2,590	52,200	76,900	66,700	110,200	
X52	2	6	6.625	0.250	17.02	2,950	2,950	52,200	76,900	66,700	110,200	
X52	2	6	6.625	0.280	18.99	2,970	3,310	52,200	76,900	66,700	110,200	
X60	1	2	2.375	0.154	3.65	2,970	5,855	60,200	81,900	75,400	110,200	
X60	1	2	2.375	0.218	5.02	2,970	7,260	60,200	81,900	75,400	110,200	
X60	1	2½	2.875	0.203	5.80	2,970	6,376	60,200	81,900	75,400	110,200	
X60	2	3	3.500	0.188	6.65	2,970	4,850	60,200	81,900	75,400	110,200	
X60	2	3	3.500	0.216	7.58	2,970	5,573	60,200	81,900	75,400	110,200	
X60	2	3	3.500	0.300	10.26	2,970	7,260	60,200	81,900	75,400	110,200	
X60	2	4	4.500	0.156	7.24	2,504	3,130	60,200	81,900	75,400	110,200	
X60	2	4	4.500	0.188	8.66	2,970	3,773	60,200	81,900	75,400	110,200	
X60	2	4	4.500	0.237	10.80	2,970	4,756	60,200	81,900	75,400	110,200	
X60	2	6	6.625	0.156	10.78	2,126	2,130	60,200	81,900	75,400	110,200	
X60	2	6	6.625	0.188	12.92	2,562	2,560	60,200	81,900	75,400	110,200	
X60	2	6	6.625	0.219	14.99	2,970	2,990	60,200	81,900	75,400	110,200	
X60	2	6	6.625	0.250	17.02	2,970	3,410	60,200	81,900	75,400	110,200	
X60	2	6	6.625	0.280	18.99	2,970	3,820	60,200	81,900	75,400	110,200	

Line Pipe Packaging

90-TON FLAT CARLOAD*: API 5L, X42, X52, X60

NOMINAL PIPE SIZE	PRODUCT DIMENSIONS					BUNDLING						BUNDLE CONFIGURATION	DIMENSIONS
	OD	t	lbs./ft.	L	pieces/car	ft./car	product weight (tons)	pieces/bundle	ft./bundle	bundle weight (tons)	bundles/car		
2	2.375	0.154	3.66	42	1,152	48,384	88.5	24	1,008	3,689	48		2 NPS @ 24 pieces H: 10.75" W: 14.5"
2	2.375	0.218	5.03	42	768	32,256	81.1	24	1,008	5,070	32		
3	3.500	0.188	6.66	45	598	26,910	89.6	13	585	3,896	46		3 NPS @ 13 pieces H: 9.75" W: 17.5"
3	3.500	0.216	7.58	45	520	23,400	88.7	13	585	4,434	40		
3	3.500	0.300	10.26	45	364	16,380	84.0	13	585	6,002	28		
4	4.500	0.156	7.24	45	400	18,000	65.1	10	450	3,257	40		4 NPS @ 10 pieces H: 12.5" W: 18"
4	4.500	0.188	8.67	45	440	19,800	85.8	10	450	3,902	44		
4	4.500	0.219	10.02	45	390	17,550	87.9	10	450	4,509	39		
4	4.500	0.237	10.80	45	360	16,200	87.5	10	450	4,860	36		
6	6.625	0.156	10.79	45	238	10,710	57.8	7	315	3,399	34		6 NPS @ 7 pieces H: 12.5" W: 26.5"
6	6.625	0.188	12.94	45	238	10,710	69.3	7	315	4,076	34		
6	6.625	0.219	15.00	45	266	11,970	89.8	7	315	4,725	38		
6	6.625	0.250	17.04	45	231	10,395	88.6	7	315	5,368	33		
6	6.625	0.280	18.99	44	210	9,240	87.7	7	308	5,849	30		

* Gondola quantity may vary.

23-TON TRUCKLOAD: API 5L, X42, X52, X60

NOMINAL PIPE SIZE	PRODUCT DIMENSIONS					BUNDLING						BUNDLE CONFIGURATION	DIMENSIONS
	OD	t	lbs./ft.	L	pieces/truck	ft./truck	product weight (tons)	pieces/bundle	ft./bundle	bundle weight (tons)	bundles/truck		
2	2.375	0.154	3.66	42	288	12,096	22.1	24	1,008	3,689	12		2 NPS @ 24 pieces H: 10.75" W: 14.5"
2	2.375	0.218	5.03	42	216	9,072	22.8	24	1,008	5,070	9		
3	3.500	0.188	6.66	45	156	7,020	23.4	13	585	3,896	12		3 NPS @ 13 pieces H: 9.75" W: 17.5"
3	3.500	0.216	7.58	45	130	5,850	22.2	13	585	4,434	10		
3	3.500	0.300	10.26	45	104	4,680	24.0	13	585	6,002	8		
4	4.500	0.156	7.24	45	140	6,300	22.8	10	450	3,257	14		4 NPS @ 10 pieces H: 12.5" W: 18"
4	4.500	0.188	8.67	45	120	5,400	23.4	10	450	3,902	12		
4	4.500	0.219	10.02	45	100	4,500	22.5	10	450	4,509	10		
4	4.500	0.237	10.80	45	90	4,050	21.9	10	450	4,860	9		
6	6.625	0.156	10.79	45	98	4,410	23.8	7	315	3,399	14		6 NPS @ 7 pieces H: 12.5" W: 26.5"
6	6.625	0.188	12.94	45	77	3,465	22.4	7	315	4,076	11		
6	6.625	0.219	15.00	45	70	3,150	23.6	7	315	4,725	10		
6	6.625	0.250	17.04	45	56	2,520	21.5	7	315	5,368	8		
6	6.625	0.280	18.99	44	56	2,464	23.4	7	308	5,849	8		

Line Pipe Packaging

90-TON CARLOAD: 25' BLACK THREADED & COUPLED; API 5L, A25, CONTINUOUS WELD PIPE

NOMINAL PIPE SIZE	PRODUCT DIMENSIONS				BUNDLING						
	OD	t	lbs./ft.	L	pieces/car	ft./car	product weight (tons)	pieces/bundle	ft./bundle	bundle weight (tons)	bundles/car
1	1.315	0.133	1.70	25	4,130	103,250	87.8	70	1,750	2,975	59
2	2.375	0.154	3.75	25	1,860	46,500	87.2	30	750	2,813	62
3	3.500	0.216	7.70	25	910	22,750	87.6	13	325	2,503	70
4	4.500	0.237	11.00	25	640	16,000	88.0	10	250	2,750	64

23-TON TRUCKLOAD: 25' BLACK THREADED & COUPLED; API 5L, A25, CONTINUOUS WELD PIPE

NOMINAL PIPE SIZE	PRODUCT DIMENSIONS				BUNDLING						
	OD	t	lbs./ft.	L	pieces/truck	ft./truck	product weight (tons)	pieces/bundle	ft./bundle	bundle weight (tons)	bundles/truck
1	1.315	0.133	1.70	25	1,120	28,000	23.8	70	1,750	2,975	16
2	2.375	0.154	3.75	25	510	12,750	23.9	30	750	2,813	17
3	3.500	0.216	7.70	25	247	6,175	23.8	13	325	2,503	19
4	4.500	0.237	11.00	25	170	4,250	23.4	10	250	2,750	17

23-TON TRUCKLOAD: 21' BLACK THREADED & COUPLED; API 5L, A25, CONTINUOUS WELD PIPE

NOMINAL PIPE SIZE	PRODUCT DIMENSIONS				BUNDLING						
	OD	t	lbs./ft.	L	pieces/truck	ft./truck	product weight (tons)	pieces/bundle	ft./bundle	bundle weight (tons)	bundles/truck
½	0.840	0.109	0.85	21	2,667	56,007	23.8	127	2,667	2,267	21
¾	1.050	0.113	1.13	21	2,002	42,042	23.8	91	1,911	2,159	22
1	1.315	0.133	1.70	21	1,330	27,930	23.7	70	1,470	2,499	19
1¼	1.660	0.140	2.27	21	969	20,349	23.1	51	1,071	2,431	19
1½	1.900	0.145	2.72	21	836	17,556	23.9	44	924	2,513	19
2	2.375	0.154	3.75	21	600	12,600	23.6	30	630	2,363	20
2½	2.875	0.203	5.80	21	380	7,980	23.1	20	420	2,436	19
3	3.500	0.216	7.70	21	286	6,006	23.1	13	273	2,102	22
4	4.500	0.237	11.00	21	200	4,200	23.1	10	210	2,310	20

23-TON TRUCKLOAD: 21' BLACK PLAIN END; API 5L, A25, CONTINUOUS WELD PIPE

NOMINAL PIPE SIZE	PRODUCT DIMENSIONS				BUNDLING						
	OD	t	lbs./ft.	L	pieces/truck	ft./truck	product weight (tons)	pieces/bundle	ft./bundle	bundle weight (tons)	bundles/truck
½	0.840	0.109	0.85	21	2,667	56,007	23.8	127	2,667	2,267	21
¾	1.050	0.113	1.13	21	2,002	42,042	23.8	91	1,911	2,159	22
1	1.315	0.133	1.68	21	1,330	27,930	23.5	70	1,470	2,470	19
1¼	1.660	0.140	2.27	21	969	20,349	23.1	51	1,071	2,431	19
1½	1.900	0.145	2.72	21	836	17,556	23.9	44	924	2,513	19
2	2.375	0.154	3.65	21	630	13,230	24.1	30	630	2,300	21
2½	2.875	0.203	5.80	21	380	7,980	23.1	20	420	2,436	19
3	3.500	0.216	7.58	21	299	6,279	23.8	13	273	2,069	23
4	4.500	0.237	10.80	21	210	4,410	23.8	10	210	2,268	21



700 South Dock Street
Sharon, PA 16146

901 Dietz Road
Warren, OH 44483

800.257.8182
info@wheatland.com
wheatland.com



Corporate Office
227 West Monroe Street
Suite 2600
Chicago, IL 60606

312.275.1600
info@zekelman.com
zekelman.com

About Wheatland Tube Energy Tubulars

Wheatland Tube produces a broad spectrum of energy tubulars, including oil country tubular goods (OCTG) and line pipe for use in for drilling, exploration, production and transportation of oil, natural gas and other resources.

For more information, contact Wheatland Tube at:

800.257.8182 or **info@wheatland.com**

Or, visit our website at wheatland.com

Follow us on:

 twitter.com/WheatlandTube

 linkedin.com/company/zekelman-industries

 youtube.com/ZekelmanIndustries

 wheatland.com/blog